



Typical “haul off pit” pump application

Usually it is necessary to pump every day until displacement depending on the pit size. Generally this would mean about five days of pumping pit fluid and cuttings prior to mud up. Once mud up occurs the pump will run about every other day through out the rest of the well. So for example, a 12 day well, would have 8 days pumping and 4 standby days for a total of \$4,560. Additionally, there would be approximately 100 gallons of diesel consumed at approximately \$3 per gallon for \$300. Set up and tear down is a total of \$750 and average mileage would run an estimated \$200. Typically overnight charges would be required for 5 nights which would be \$375. Total pump charge for a typical well would be approximately \$6,185.

Typical poly pipe rental

Generally the average amount of pipe required to move drilling fluids out from under circle irrigation is approximately 2,500 feet. Haul off pits vary in distance according to the KCC regulation. The estimated average cost of delivery, lay down and pick up 2,500 feet of 3” poly pipe is \$1,650.

Pump capabilities

The most extreme use for the Monster Pump to date is a well in SW Kansas where it pumped drilling fluids to a haul pit that was over 5,300 feet from the well. Additionally, the haul pit was approximately 50 feet higher in elevation than the pump. It is estimated that Monster Pump – pumped over 8,500 barrels of fluid during the drilling of this well.

1-877-MUDHAWK

2115 B E. 7TH
HAYS, KS 67601

30305 BARKER
PRATT, KS 67124

1505 W TENTH
HUGOTON, KS 67951

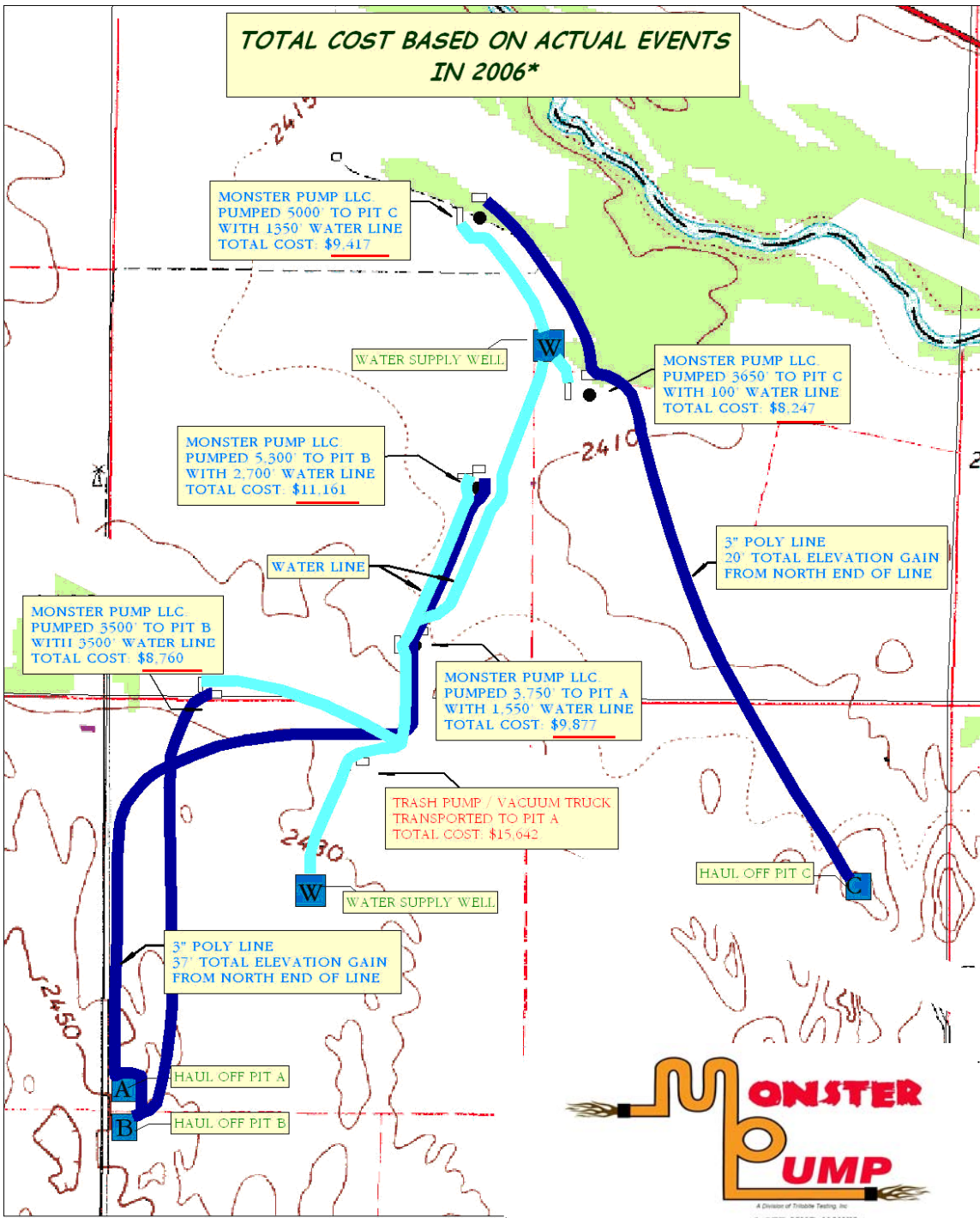

1-877-MUD-HAWK

2115 B E. 7TH
HAYS, KS 67601

30305 BARKER
PRATT, KS 67124

1505 W. TENTH
HUGOTON, KS 67951